

PRESSURE GAUGES WITH DIAPHRAGM IN CAST IRON CASES



**Diameter 100 and 160
with or without filling**

Hard requirements, such as for use in industrial production.
The use of highly viscous and crystallizing substances open flanges
are used which can be cleaned better.



Type	5921	7851	5931	7861	Options
Diameter	100		160		
Symbol					Esteroil (silicone-free)
Accuracy class	1,6 according to EN 837-3				
Ranges	0..16 mbar up to 0...250 mbar: flange Ø 160 mm 0...0,4 bar up to 0...40 bar: flange Ø 100 mm and ranges for neg. or neg. and pos. overpressure				MPa, kPa
Applications	Constant load: up to the end of scale value Alternating load: up to 0,9-x end of scale value Short time: 1,3 x overload capacity				underpressure proof to -1bar
Overload protection	</=0,25 bar: 5 x end of scale value >0,25 bar up to 2,5 bar: 3 x end of scale value > 2,5 bar: 5xend of scale value, max. 40 bar				overload safety 10 x end of scale value max. 40 bar
Case	Steel, black or stainless steel				
Ring	Bayonet ring made of stainless steel				
Window	Flat instrument glass				
Dial	Al white, scale and printing black				Dual scale
Pointer	Al black				
Movement	CuZn-alloy, bearing parts nickel silver				
Measuring element	elastic, stainless steel 1.4571, from 2,5 bar steel				
Upper flange	Steel				
Thread	G 1/2 B, M20x1,5				others on request
Temperatures	Medium: -20°C up to 100°C, ambient: -20°C up to 60°C				
Protection	IP 54 (with filling IP 65) acc. to EN 60529/IEC 529				
Seal to pressure chamber	NBR (Perbunan) - with filling (NBR-Balg)				Metal bellows (stainless steel)
Open process connection / wetted parts					acc. to DIN, DN 15 up to DN 80/ PTFE, Hastelloy, Monel, Nickel, Tantal, Titan, Silver

Dimensioned drawing

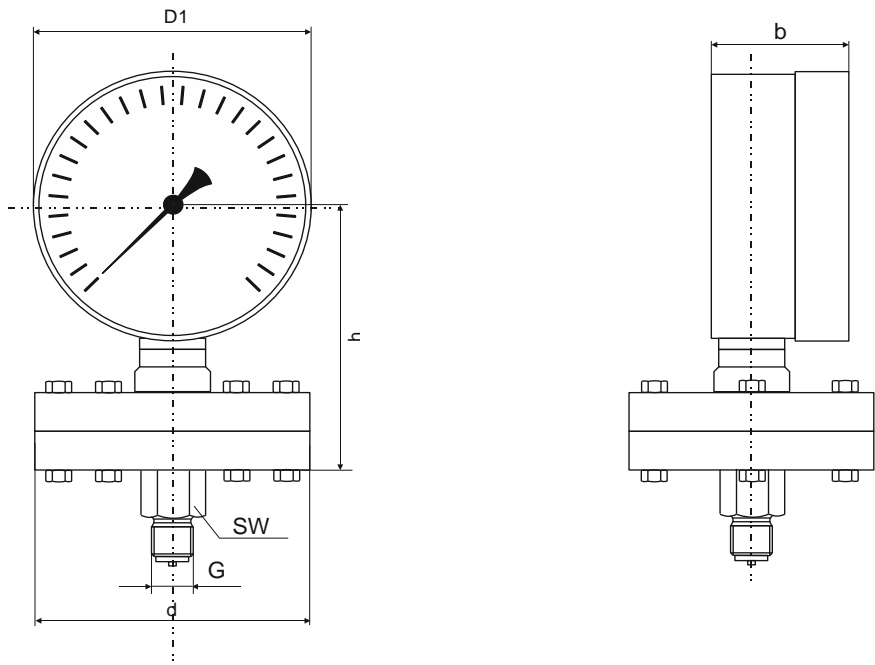

ND	bar	Dimensions in mm							Weight (kg)	
		d	a	b	D	G	h	SW	unfilled	filled
100	<= 0,25	160	15,5	49	101	G1/2B	127	22	3,4	3,9
160	<= 0,25	160	15,5	49	161	G1/2B	156	22	4,3	5,2
100	>= 0,4	100	15,5	49	101	G1/2B	127	22	2,1	2,6
160	>= 0,4	100	15,5	49	161	G1/2B	156	22	3	3,9

Options with flange

DIN DN 25

DIN DN 50

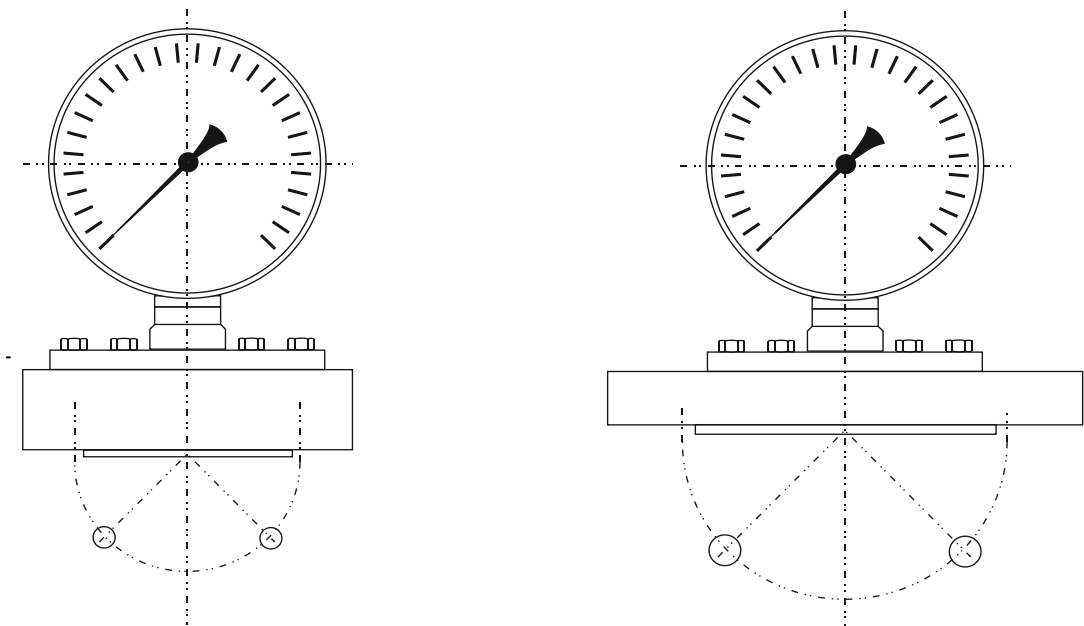

Dimensioned drawings see sheet 1.29, page 4